

MICHAEL RAYMOND LE ROY & MARIE MARLINDA
VOL. 811 - PG. 1224
11-373800

LOIS A. KUEBEL
VOL. 1033 - PG. 376
11-018400

FRANK & JOAN DOBNIKAR
VOL. 793 - PG. 1123
11-382650

FRANK & JOAN DOBNIKAR
VOL. 797 - PG. 522
11-388759

EVERETT & VIVIAN WILT
VOL. 399 - PG. 983
11-379100
CHILLICOTHE RD.

TOTAL - 5.486 ACRES
SPLIT "A" - 2.510 ACRES
BALANCE - 2.976 ACRES
R/W - 0.100 ACRES
NET - 2.876 ACRES

SPLIT "A" - 2.510 ACRES
SPLIT "B" + 0.125 ACRES
TOTAL - 2.635 ACRES

(SPLIT "A" - 2.510 AC)

TOTAL - 1.861 ACRES
SPLIT "B" - 0.125 ACRES
NET - 1.736 ACRES

FRANCIS & ANNE J. SKOMROCK
VOL. 597 - PG. 1159
11-316160
12156 CHILLICOTHE RD.

TODD D. STEVENS
VOL. 1585 - PG. 326
11-234200
12144 CHILLICOTHE RD.

DANIEL R & CHRISTINE A. HUBBS
VOL. 843 - PG. 1290
11-188900
12128 CHILLICOTHE RD.

JAMES & LAURA SUSTAR
VOL. 797 - PG. 598
11-388730

S/L 11
RONALD & VALERIE Cwiklinski
VOL. 794 - PG. 468
11-388729

RESERVE OF CHESTER
VOL. 16 - PG. 65-6

CURVE	LENGTH	RADIUS	TANGENT	CHORD	BEARING	DELTA
C1	174.53	250.00	90.99	171.01	N16°15'54"W	39°59'59"
C2	68.33	280.00	34.36	68.20	N03°15'37"W	13°59'25"
C3	127.11	280.00	64.67	126.02	N23°15'37"W	26°20'34"
C4	4.34	40.00	2.17	4.34	S52°09'26"E	06°12'57"
C5	32.32	40.00	17.10	31.44	S06°59'15"E	46°17'14"
CL	92.00	75.00	53.24	86.83	S19°07'47"E	70°44'18"

NOTE: ALL IRON PINS SET ARE
5/8" X 30" AND CAPPED
BABCOCK, JONES & ASSOC.

EXISTING UTILITIES NOTE:
THE SIZE AND LOCATION, BOTH HORIZONTAL AND VERTICAL
OF THE UNDERGROUND UTILITIES SHOWN HEREON, HAVE BEEN
OBTAINED BY A SEARCH OF AVAILABLE RECORDS.
VERIFICATION BY FIELD OBSERVATION HAS BEEN CONDUCTED
WHERE PRACTICAL, HOWEVER, BABCOCK, JONES AND ASSOCIATES
INC. DOES NOT GUARANTEE THE COMPLETENESS NOR ACCURACY
THEREOF.

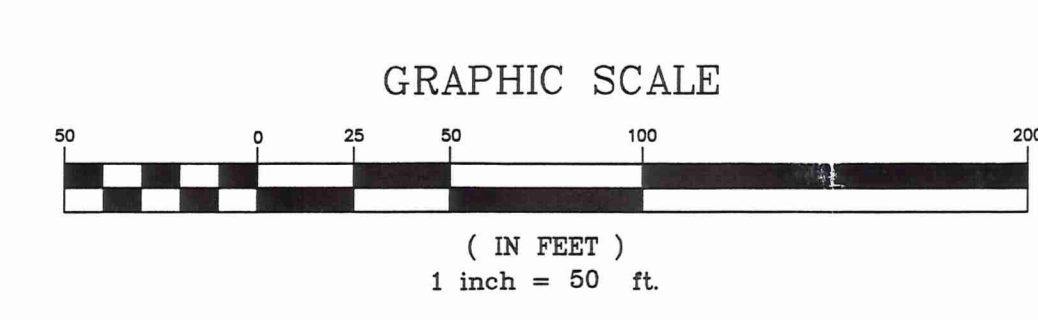

SURVEY PLAT & LEGAL DESCRIPTION
APPROVED PER R.O. 315.251
RAK 8/27/04
OFFICE OF THE REVISOR
GEAUGA COUNTY ENGINEER

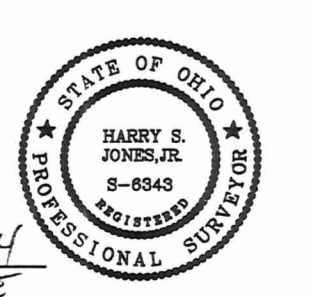

REV. NO.	DESCRIPTION	DATE	BY	CHK'D
1	ADDED NEW CURVE DATA	7/27/04	N.S.	H.J.
2	REVISIONS PER GEAUGA COUNTY ENGINEER	8/25/04	H.S.	H.S.

bj BABCOCK, JONES AND ASSOCIATES, INC
CIVIL ENGINEERS - SURVEYORS - LAND PLANNERS
PAINESVILLE OHIO 44077
PHONE: 440-357-1811 FAX: 440-357-9173

DATE	7/02/04
DESIGN BY	HJ
DRAWN BY	NS
APPROVED BY	HJ

PLAT OF SURVEY
FOR
JIM SUSTAR Vol. 16 - Pg. 65
12142 RESERVE LANE S/L 12 RESERVE OF CHESTER SUB.
TOWNSHIP OF CHESTER GEAUGA COUNTY STATE OF OHIO

SCALE	1" = 50'
JOB NO.	04-57
SHEET	1 OF 1

CHE00140

CHE00140



BABCOCK - JONES
CIVIL ENGINEERS AND SURVEYORS

Sustar-wilt
Pickup date
8-27-04

1924 MENTOR AVE., PAINESVILLE, OHIO 44077 PHONE (440) 357-1811 FACSIMILE (440) 357-9173

August 2, 2004

REVISED LEGAL DESCRIPTION OF BALANCE OF PROPERTY FOR
EVERETT WILT.

Situated in the Township of Chester, County of Geauga and State of Ohio and known as being a part of Lot No. 11, Tract No. 2 and also being further bounded and described as follows;

Beginning at a 5/8" iron pin found in a monument box at the intersection of the centerline of Sherman Road (60 feet wide) and the centerline of Chillicothe Road - S.R. 306 - (60 feet wide);

Thence North 3°44'05" East along the centerline of Chillicothe Road - S.R. 306 - a distance of 1,721.62 feet to the northeasterly corner of land conveyed to Michael Raymond LeRoy and Marie MarLinda by deed recorded in Volume 811, Page 1224 of Geauga County Deed Records, Permanent Parcel No. 11-373800, said point being the principal place of beginning;

COURSE I: Thence North 85°58'33" West along the northerly line of Michael Raymond LeRoy and Marie Marlinda, passing thru a 1" iron pipe found at 30.00 feet, a distance of 904.71 feet to a 5/8" x 30" iron pin set and capped Babcock, Jones & Associates, Inc.;

COURSE II: Thence North 4°25'45" East a distance of 142.45 feet to a 5/8" x 30" iron pin set and capped Babcock, Jones & Associates, Inc. on the southerly line of land conveyed to Francis E. and Anne J. Skomrock by deed recorded in Volume 597, Page 1159 of Geauga County Deed Records, Permanent Parcel No. 11-316160;

COURSE III: Thence South 86°04'56" East along the southerly line and to the southeasterly corner of Francis E. and Anne J. Skomrock, passing thru a 1" iron pipe found at 874.73 feet, a distance of 904.73 feet to a point on the centerline of Chillicothe Road;

COURSE IV: Thence South 4°25'45" West along the centerline of Chillicothe Road - S.R. 306, a distance of 144.13 feet to the principal place of beginning and containing 2.976 acres land as surveyed and described by Harry S. Jones, Registered Surveyor No. 6343 in August, 2004.

Bearings are based upon the centerline of Chillicothe Road - S.R. 306 - North 4°25'45" East and are used to describe angles only;

1005 28 2004

CHE00140

REVISED LEGAL DESCRIPTION OF BALANCE OF PROPERTY FOR
EVERETT WILT
CONTINUED
PAGE 2.

Out of existing Parcel No. 11-379100.

Prior Deed of Records - Volume 399, Page 983.

Harry S. Jones #6343

Harry S. Jones, P.S. #6343

8/25/04

Date

SURVEY PLAT & LEGAL DESCRIPTION
APPROVED PER R.C. 315.251

PAK 8/27/04

OFFICE OF THE *Revised*
GEAUGA COUNTY ENGINEER



APR 28 2004

Handwritten mark

CHE00140

VOL 1741 P 61
11-389 248



BABCOCK - JONES
CIVIL ENGINEERS AND SURVEYORS

1924 MENTOR AVE., PAINESVILLE, OHIO 44077 PHONE (440) 357-1811 FACSIMILE (440) 357-9173

August 25, 2004

REVISED LEGAL DESCRIPTION OF LOT SPLIT 'B' FOR
JIM SUSTAR.

Situated in the Township of Chester, County of Geauga and State of Ohio and known as being a part of Lot No. 10 and 11, Tract No. 2 and also being a part of former Sublot No. 12 in Reserve of Chester Subdivision as recorded in Volume 16, Page 65 of Geauga County Plat Records, and being further bounded and described as follows;

Beginning at the intersection of the centerline of Sherman Road (60 feet wide) and the centerline of Reserve Lane (60 feet wide);

Thence North 3°44'05" East along the centerline of Reserve Lane, passing thru a 5/8" iron pin found in a monument box at 30.00 feet, a distance of 1,659.35 feet to a 5/8" iron pin found in a monument box;

Thence South 86°15'55" East a distance of 30.00 feet to a 5/8" iron pin found on the easterly right-of-way line of Reserve Lane and also being on the southerly line of land conveyed to Frank and Joan Dobnikar by deed recorded in Volume 797, Page 592 of Geauga County Deed Records, Permanent Parcel No. 11-388759;

Thence along the westerly line ad to the northwesterly corner of Frank and Joan Dobnikar and the easterly right-of-way line of Reserve Lane along the arc of a curve deflecting to the left, a distance of 68.33 feet, with a radius of 280.00 feet, with a chord of 68.20 feet which bears North 3°15'37" West with a chord angle of 13°59'25" to a 5/8" x 30" iron pin set and capped Babcock, Jones & Associates, Inc., at the principal place of beginning;

COURSE I: Thence along the arc of the easterly right-of-way line of Reserve Lane deflecting to the left a distance of 127.11 feet, with a radius of 280.00 feet, with a chord of 126.02 feet which bears North 23°15'37" West with a central angle of 26°00'34" to a 5/8" x 30" iron pin set and capped Babcock, Jones & Associates, Inc.;

COURSE II: Thence North 36°15'54" West along the easterly right-of-way of Reserve Lane a distance of 18.76 feet to a 5/8" x 30" iron pin set and capped Babcock, Jones & Associates, Inc.;

APR 2 2004

CFE 00140
REVISED LEGAL DESCRIPTION OF LOT SPLIT 'B' FOR JIM SUSTAR

CONTINUED

PAGE 2

- COURSE III: Thence along the arc of the easterly right-of-way line of Reserve Lane deflecting to the right a distance of 4.34 feet, with a radius of 40.00 feet and a chord of 4.34 feet which bears North 33°09'26" West with a central angle of 6°12'57" to a 5/8" x 30" iron pin set and capped Babcock, Jones & Associates, Inc.;
- COURSE IV: Thence North 86°15'35" East a distance of 83.30 feet to a 1" iron pipe found at the southwesterly corner of land conveyed to Francis and Anne Skomrock by deed recorded in Volume 597, Page 1159 of Geauga County Deed Records, Permanent Parcel No. 11-316160, said point also being on the Lot Line between Lot Nos. 10 and 11 and also the northwesterly corner of land conveyed to Everett and Vivian Wilt by deed recorded in Volume 399, Page 983 of Geauga County Deed Records, Permanent Parcel No. 11-379100;
- COURSE V: Thence South 4°43'03" West along said Lot Line and the westerly line and to the southwesterly corner of Everett and Vivian Wilt, a distance of 141.03 feet to a 1" iron pipe found on the northerly line of Frank and Joan Dobnikar by deed recorded in Volume 793, Page 1123 of Geauga County Deed Records, Permanent Parcel No. 11-382650;
- COURSE VI: Thence North 85°58'33" West along said northerly line of Frank and Joan Dobnikar a distance of 8.31 feet to the principal place of beginning and containing 0.125 of an acre of land as surveyed and described by Harry S. Jones, Registered Surveyor No. 6343 in August, 2004.

Bearings are based upon the centerline of Reserve Lane being North 3°44'05" East and are used to describe angles only;

Out of existing Parcel No. 11-388730.

Prior Deed of Record - Volume 797, Page 598;

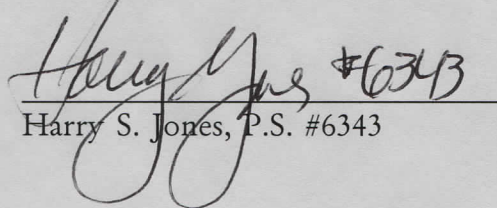
Harry S. Jones, P.S. #6343

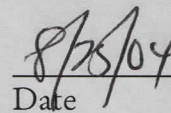
Date

SURVEY PLAT & LEGAL DESCRIPTION
APPROVED PER R.C. 315.251

PAK 8/27/04

OFFICE OF THE *Revised*
GEAUGA COUNTY ENGINEER



CHE 00140



BABCOCK - JONES
CIVIL ENGINEERS AND SURVEYORS

1924 MENTOR AVE., PAINESVILLE, OHIO 44077 PHONE (440) 357-1811 FACSIMILE (440) 357-9173

August 25, 2004

REVISED LEGAL DESCRIPTION OF LOT SPLIT 'A' FOR JIM SUSTAR.

Situated in the Township of Chester, County of Geauga and State of Ohio and known as being a part of Lot No. 11, Tract No. 2 and also being further bounded and described as follows;

Beginning at the intersection of the centerline of Sherman Road (60 feet wide) and the centerline of Reserve Lane (60 feet wide);

Thence North 3°44'05" East along the centerline of Reserve Lane, passing thru a 5/8" iron pin found in a monument box at 30.00 feet, a distance of 1,659.35 feet to a 5/8" iron pin found in a monument box;

Thence South 86°15'55" East a distance of 30.00 feet to a 5/8" iron pin found on the easterly right-of-way line of Reserve Lane and also being on the southerly line of land conveyed to Frank and Joan Dobnikar by deed recorded in Volume 797, Page 592 of Geauga County of Records, Permanent Parcel No. 11-388759;

Thence along the westerly line and to the northwesterly corner of Frank and Joan Dobnikar and the easterly right-of-way line of Reserve Lane along the arc of a curve deflecting to the left, a distance of 68.33 feet, with a radius of 280.00 feet, with a chord of 68.20 feet which bears North 3°15'37" West with a chord angle of 13°59'25" to a 5/8" x 30" iron pin set and capped Babcock, Jones & Associates, Inc.;

Thence South 89°59'44" East along the northerly line of Frank and Joan Dobnikar a distance of 8.31 feet to a 1" iron pipe found at the intersection of Lot Nos. 9, 10, 11 and 12, said point being the principal place of beginning;

COURSE I: Thence North 4°43'03" East along said Lot Line between Lot Nos. 10 and 11, and the easterly line of land conveyed to James and Laura Sustar by deed recorded in Volume 797, Page 598 of Geauga County Deed Records, Permanent Parcel No. 11-388730, a distance of 141.03 feet to a 1" iron pipe found at the southwesterly corner of land conveyed to Francis E. and Anne J. Skomrock by deed recorded in Volume 597, Page 1159 of Geauga County Deed Records, Permanent Parcel No. 11-316160;

APRS 29 JUL

[Handwritten signature]

CHE 00140

REVISED LEGAL DESCRIPTION OF LOT SPLIT 'A' FOR JIM SUSTAR

CONTINUED

PAGE 2.

COURSE II: Thence South 86°04'56" East along the southerly line of Francis E. and Anne J. Skomrock a distance of 771.00 feet to a 5/8" x 30" iron pin set and capped Babcock, Jones & Associates, Inc.;

COURSE III: Thence South 4°25'45" West a distance of 142.45 feet to a 5/8" x 30" iron pin set and capped Babcock, Jones & Associates, Inc. on the northerly line of land conveyed to Michael Raymond LeRoy and Marie MarLinda by deed recorded in Volume 811, Page 1224 of Geauga County Deed Records, Permanent Parcel No. 11-373800;

COURSE IV: Thence North 85°58'33" West along the northerly line of Michael Raymond LeRoy and Marie MarLinda and the northerly line of land conveyed to Lois A. Wenzel by deed recorded in Volume 1033, Page 376 by Geauga County Deed Records, Permanent Parcel No. 11-018400 and Frank and Joan Dobnikar a distance of 771.70 feet to the principal place of beginning and containing 2.510 of an acre of land as surveyed and described by Harry S. Jones, Registered Surveyor No. 6343 in August, 2004.

Bearings are based upon the centerline of Reserve Lane North 3°44'05" East and are used to describe angles only;

Out of existing Parcel No. 11-379100.

Prior deed of record Volume 399, Page 983.

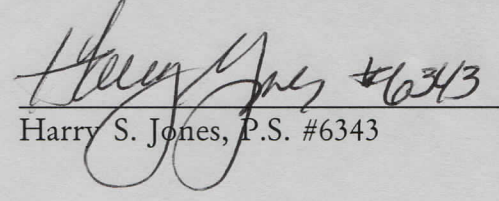
Harry S. Jones, P.S. #6343

8/28/04
Date

SURVEY PLAT & LEGAL DESCRIPTION
APPROVED PER R.C. 315.251

PAK 8/27/04
OFFICE OF THE *Revised*
GEAUGA COUNTY ENGINEER

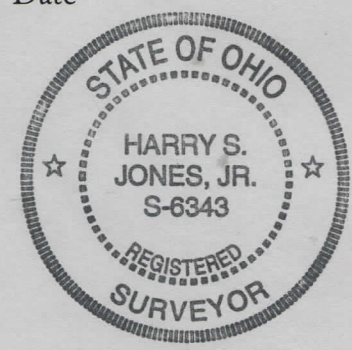

ANG S 2 S 30A

7-109

CHE00140

VOL 1741 P 66

11-389248



BABCOCK - JONES
CIVIL ENGINEERS AND SURVEYORS

1924 MENTOR AVE., PAINESVILLE, OHIO 44077 PHONE (440) 357-1811 FACSIMILE (440) 357-9173

August 25, 2004

REVISED LEGAL DESCRIPTION OF TOTAL VACANT PARCEL FOR
JIM SUSTAR.

Situated in the Township of Chester, County of Geauga and State of Ohio and known as being a part of Lot No. 10 and 11, Tract No. 2 and also being a part of former Sublot No. 12 in Reserve of Chester Subdivision as recorded in Volume 16, Page 65 of Geauga County Plat Records, and being further bounded and described as follows;

Beginning at the intersection of the centerline of Sherman Road (60 feet wide) and the centerline of Reserve Lane (60 feet wide);

Thence North 3°44'05" East along the centerline of Reserve Lane, passing thru a 5/8" iron pin found in a monument box at 30.00 feet, a distance of 1,659.35 feet to a 5/8" iron pin found in a monument box;

Thence South 86°15'55" East a distance of 30.00 feet to a 5/8" iron pin found on the easterly right-of-way line of Reserve Lane and also being on the southerly line of land conveyed to Frank and Joan Dobnikar by deed recorded in Volume 797, Page 592 of Geauga County Deed Records, Permanent Parcel No. 11-388759;

Thence along the westerly line ad to the northwesterly corner of Frank and Joan Dobnikar and the easterly right-of-way line of Reserve Lane along the arc of a curve deflecting to the left, a distance of 68.33 feet, with a radius of 280.00 feet, with a chord of 68.20 feet which bears North 3°15'37" West with a chord angle of 13°59'25" to a 5/8" x 30" iron pin set and capped Babcock, Jones & Associates, Inc., at the principal place of beginning;

COURSE I: Thence along the arc of the easterly right-of-way line of Reserve Lane deflecting to the left a distance of 127.11 feet, with a radius of 280.00 feet, with a chord of 126.02 feet which bears North 23°15'37" West with a central angle of 26°00'34" to a 5/8" x 30" iron pin set and capped Babcock, Jones & Associates, Inc.;

COURSE II: Thence North 36°15'54" West along the easterly right-of-way of Reserve Lane a distance of 18.76 feet to a 5/8" x 30" iron pin set and capped Babcock, Jones & Associates, Inc.;

AND 2'S 3UA

CH1F00140

LEGAL DESCRIPTION OF TOTAL VACANT PARCEL FOR JIM SUSTAR

CONTINUED

PAGE 2

- COURSE III: Thence along the arc of the easterly right-of-way line of Reserve Lane deflecting to the right a distance of 4.34 feet, with a radius of 40.00 feet and a chord of 4.34 feet which bears North 33°09'26" West with a central angle of 6°42'57" to a 5/8" x 30" iron pin set and capped Babcock, Jones & Associates, Inc.;
- COURSE IV: Thence North 86°15'35" East a distance of 83.30 feet to a 1" iron pipe found at the southwesterly corner of land conveyed to Francis E. and Anne J. Skomrock by deed recorded in Volume 597, Page 1159 of Geauga County Deed Records, Permanent Parcel No. 11-316160, said point also being on the Lot Line between Lot Nos. 10 and 11;
- COURSE V: Thence South 86°04'56" East along said southerly line of Francis E. and Anne J. Skomrock a distance of 771.00 feet to a 5/8" x 30" iron pin set and capped Babcock, Jones & Associates, Inc.
- COURSE VI: Thence South 4°25'45" West, a distance of 142.45 feet to a 5/8" x 30" iron pin set and capped Babcock, Jones & Associates, Inc. on the northerly line of land conveyed to Michael Raymond LeRoy and Marie MarLinda by deed recorded in Volume 811, Page 1224 of Geauga County Deed Records, Permanent Parcel No. 11-373800;
- COURSE VII: Thence North 85°58'33" West along said northerly line of Michael Raymond LeRoy and Marie MarLinda and the northerly line of land conveyed to Lois A. Wenzel by deed recorded in Volume 1033, Page 376 of Geauga County Deed Records, Permanent Parcel No. 11-018400 and Frank and Joan Dobnikar a distance of 780.01 feet to the principal place of beginning and containing 2.635 acres of land, as surveyed and described by Harry S. Jones, Registered Surveyor No. 6343 in August, 2004.

Bearings are based upon the centerline of Reserve Lane being North 3°44'05" East and are used to describe angles only.

Out of Permanent Parcel Nos. 11-379100 and 11-388730.

Prior Deed Volume 399, Page 983.

2.510 acres from Permanent Parcel No. 11-379100
0.125 acres from Permanent Parcel No. 11-388730
 2.635 acres total

Harry S. Jones #6343
 Harry S. Jones, F.S. #6343

8/25/04
 Date

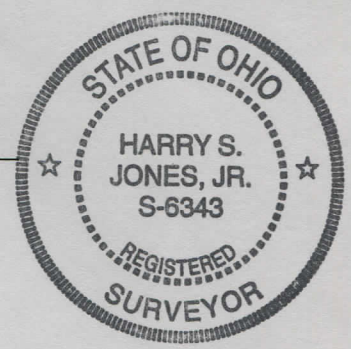

SURVEY PLAT & LEGAL DESCRIPTION
 APPROVED PER R.C. 315.251

PAK *8/27/04*
 OFFICE OF THE *Revised*
 GEauga COUNTY ENGINEER



BABCOCK - JONES
CIVIL ENGINEERS AND SURVEYORS

Vol 1741 Pg 11
11-388730

1924 MENTOR AVE., PAINESVILLE, OHIO 44077 PHONE (440) 357-1811 FACSIMILE (440) 357-9173

August 26, 2004

REVISED LEGAL DESCRIPTION OF BALANCE OF FORMER SUBLOT NO. 12
FOR JIM SUSTAR.

Situated in the Township of Chester, County of Geauga and State of Ohio and known as being a part of Lot No. 10, Tract No. 2 and also being a part of former Sublot No. 12 in Reserve of Chester Subdivision as recorded in Volume 16, Page 65 of Geauga County Plat Records and being further bounded and described as follows;

Beginning at the interaction of the centerline of Sherman Road (60 feet wide) and the centerline of Reserve Lane (60 feet wide);

Thence North $3^{\circ}44'05''$ East along the centerline of Reserve Lane, passing thru a $5/8''$ iron pin found in a monument box at 30.00 feet, a distance of 1,659.35 feet to a $5/8''$ iron pin found in a monument box;

Thence along the arc of the centerline of Reserve Lane deflecting to the left a distance of 174.53 feet, with a radius of 250.00 feet and a chord of 171.01 feet which bears North $16^{\circ}15'54''$ West with a central angle of $39^{\circ}59'59''$ to a $5/8''$ iron pin in a monument box;

Thence along the centerline of Reserve Lane North $36^{\circ}15'54''$ West a distance of 110.00 feet to a $5/8''$ iron pin found in a monument box;

Thence North $35^{\circ}30'04''$ East a distance of 75.00 feet to a $5/8''$ iron pin found at the intersection of the northerly right-of-way line of Reserve Lane and the southeasterly corner of Sublot No. 11 in Reserve of Chester Subdivision said point being the principal place of beginning;

COURSE I: Thence North $17^{\circ}05'16''$ West along the easterly line and to the northeasterly corner of Sublot No. 11 a distance of 365.87 feet to a $5/8''$ iron pin found on the southerly line of land conveyed to Dorothy Racut, Trustee by deed recorded in Volume 1118, Page 628 of Geauga County Deed Records, Permanent Parcel No. 11-276800;

COURSE II: Thence South $86^{\circ}24'24''$ East along the southerly line of Dorothy Racut, Trustee a distance of 259.78 feet to a $5/8''$ iron pin found on the westerly line of land conveyed to Daniel R. and Christine A. Hibbs by deed recorded in Volume 843, Page 1290 of Geauga County Deed Records, Permanent Parcel No. 11-168900, said point also being on the Lot Line between Lot Nos. 10 and 11;

CHED0140

LEGAL DESCRIPTION OF BALANCE OF FORMER SUBLOT NO. 12
FOR JIM SUSTAR.
CONTINUED
PAGE 2

COURSE III: Thence South 4°43'03" West along said Lot Line and the westerly lines of Daniel R. and Christine A. Hibbs and Todd D. Stevens by deed recorded in Volume 1585, Page 326 of Geauga County Deed Records, Permanent Parcel No. 11-234200, and the westerly line and to the southwesterly corner of Francis E. and Anne J. Skomrock by deed recorded in Volume 597, Page 1159 of Geauga County Deed Records, Permanent Parcel No. 11-316160, a distance of 442.75 feet to a 1" iron pipe found;

COURSE IV: Thence South 86°15'35" West a distance of 83.30 feet to a 5/8" x 30" iron pin set and capped Babcock, Jones & Associates, Inc. on the easterly right-of-way line of Reserve Lane;

COURSE V: Thence along the arc of the easterly right-of-way line of Reserve Lane deflecting to the right a distance of 32.32 feet, with a radius of 40.00 feet, with a chord of 31.44 feet which bears North 6°54'15" West with a central angle of 46°17'14" to a 5/8" x 30" iron pin set and capped Babcock, Jones & Associates, Inc.;

COURSE VI: Thence along the arc of the easterly right-of-way line of Reserve Lane deflecting to the left a distance of 92.60 feet, with a radius of 75.00 feet and a chord of 86.83 feet which bears North 19°07'47" West with a central angle of 70°44'18" to the principal place of beginning and containing 1.736 acres of land as surveyed and described by Harry S. Jones, Registered Surveyor No. 6343 in August, 2004.

Bearings are based upon the centerline of Reserve Lane being North 36°15'54" West and are used to describe angles only;

Out of existing Parcel No. 11-388730.

Prior Deed of Record - Volume 797, Page 598.

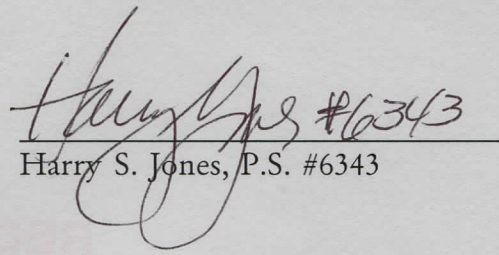
Harry S. Jones, P.S. #6343

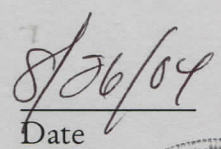
Date

SURVEY PLAT & LEGAL DESCRIPTION
APPROVED PER R.C. 315.251

P9K 8/27/04
OFFICE OF THE *Revised*
GEAUGA COUNTY ENGINEER

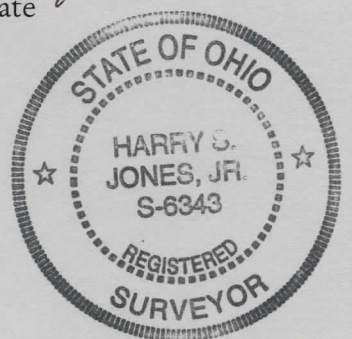

109-1008 8 S 2UA